

## Self-Priming Pumps

### Sta-Rite CSP/CCSP Series Pumps

Commercial self-priming pump. Cast iron with bronze impeller. 6" suction x 4" discharge flanged connections. 3450 rpm, 230/460 volt, 3 phase. Oversized hair and lint strainer with O-ring seal and electro-polished stainless steel basket. Strainer ordered separately. Pumps and strainers available without corrosion resistant epoxy coatings (CSP) or with epoxy coatings on all wetted surfaces (CCSP).

#### Cast Iron:

- SR13005 - Sta-Rite CSP, 7.5 HP
- SR13010 -- Sta-Rite CSP, 10 HP
- SR13015 - Sta-Rite CSP, 15 HP
- SR13020 - Sta-Rite CSP, 20 HP
- SR13025 - Sta-Rite Hair & Lint Strainer

#### Epoxy Coated:

- SR13006 - Sta-Rite CCSP, 7.5 HP
- SR13011 - Sta-Rite CCSP, 10 HP
- SR13016 - Sta-Rite CCSP, 15 HP
- SR13021 - Sta-Rite CCSP, 20 HP
- SR13026 - Sta-Rite Hair & Lint Strainer



CSP/CCSP

**Sta-Rite "D" Series Pumps** – Commercial self-priming cast iron pump with bronze impeller. High suction lift capacity. 3 phase, 230/460 volt motor. High head pump. Strainer ordered separately. Medium head pumps and 1 phase, 230 volt motors also available.

- SR13055 - 3 HP, 95 gpm @ 80' TDH
- SR13060 - 5 HP, 145 gpm @ 80' TDH
- SR13065 - 6" hair and lint strainer, cast iron
- SR13070 - 8" hair and lint strainer, cast iron

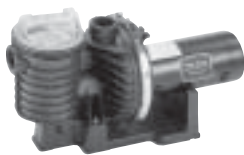

D-Series Pump

**Sta-Rite Max-E-Glas II Pumps** – Self-priming pumps made with glass reinforced thermoplastic. Energy efficient. 2" FPT ports on suction and discharge for easy installation. ¾ HP and 1 HP have 115/230 volt motors. 1.5 HP to 3 HP have 230 volt motors. Hair and lint strainer included.

- SR13075 - 3/4 HP, 55 gpm @ 60' TDH
- SR13080 - 1 HP, 70 gpm @ 60' TDH
- SR13085 - 1.5 HP, 105 gpm @ 60' TDH
- SR13090 - 2 HP, 115 gpm @ 60' TDH
- SR13095 - 3 HP, 145 gpm @ 60' TDH

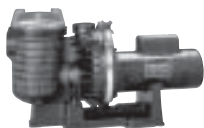

Max-E-Glas Pump

**Astral Self-Priming pumps** – Specially designed for smaller commercial swimming pools and spas, where high performance and self-priming characteristics are necessary.

- Cast iron construction
- Bronze impellers
- Single & three-phase models available
- Strainer sold separately

#### Medium Head:

- AFA171D - 3 HP - 1 Phase - 230 V
- AFA171D3 - 3 HP - 3 Phase - 230/460 V
- AFA111D - 5 HP - 1 Phase - 230 V
- AFA111D3 - 5 HP - 3 Phase - 230/460 V



Astral Self-Priming Pump

**3 & 5 HP Cast Iron Pump Strainers** – Heavy cast iron construction. Separate bolt-on cast body and cover; threaded locking handles. Stainless steel basket.

- AFA051S - 6" cast iron pot, 2" NPT suct., 3 HP
- AFA098S - 8" cast iron pot, 3" NPT suct., 5 HP



3 & 5 Cast Iron Pump Strainers

**Astral 7.5, 10, 15, and 20 HP Cast Iron Pumps** – Specially designed for large commercial swimming pools, spas, or water parks where high performance and self-priming characteristics are necessary.

- Cast iron construction with bronze impellers and wear rings
- Available in "standard" (non-epoxy coated) or "epoxy coated" models.
- Dimensionally compatible to most installations for easier hook-up on new retrofit projects.

- Capacity to 750 GPM
  - 4" Discharge
- Pumps do not include hair & lint strainer; please order separately

#### Standard Models:

- AF142C - 7.5 HP - 1 phase - 230 V
- AF142C3 - 7.5 HP - 3 phase - 230/460 V
- AF143C - 10 HP - 1 phase - 230 V
- AF143C3 - 10 HP - 3 phase - 230/460 V
- AF144C3 - 15 HP - 3 phase - 230/460 V
- AF145C3 - 20 HP - 3 phase - 230/460 V



7.5 - 20 HP Pump

**Astral Cast Iron Strainers – 7.5, 10, 15 & 20 HP** – Rugged cast iron construction. Separate bolt-on cast body and cover; Stainless Steel toggle bolts, ductile iron wing nuts. Stainless Steel basket.

- AFA184S - Standard strainer 6" suction (flanged)



7- 20 HP Strainer

**Astral 25, 30, 40, and 50 HP Cast Iron Pumps** – Specially designed for large commercial applications where high performance and self-priming characteristics are necessary.

- Cast iron construction
- Bronze impellers
- Single & three phase models available
- 3450 RPM
- Strainer sold separately

Please contact your sales representative for performance curves and proper sizing.

- AFT1872 - 25 HP - 3 Phase - 230 V
- AFT1882 - 30 HP - 3 Phase - 230 V
- AFT1900 - 40 HP - 3 Phase - 230 V
- AFT1902 - 50 HP - 3 Phase - 230 V



25-50 HP pump

**Polyester Strainer for all models** – Constructed of fiberglass reinforced polyester with PVC flanges, stainless steel hair and lint basket. Features drain port for easy winterizing.

- AF15648 - Inlet/outlet 3"
- AF15649 - Inlet/outlet 4"
- AF15653 - Inlet/outlet 6"
- AF15654 - Inlet/outlet 8"



Polyester Strainer

## WhisperFlo High Performance Pumps – Energy Efficient Swimming Pool Pumps

40% glass-filled thermoplastic with the Cam & Ramp “see thru” lid design. Self-priming, high flow with patented funnel-flo diffusers. 2 in. suction and discharge ports. Motor features threaded shaft, 56 frame and square flange.

- The WhisperFlo pump has undergone rigorous ETL testing for quiet, efficient operation
- Compatible with all cleaning systems, various filters and jet action spas
- Built-in Strainer Pot and Volute
- Energy-Efficient Square Flange Motor
- Lower HPs deliver higher performance
- Heavy-duty/durable construction
- Pump is designed for long life
- Three Year Warranty



Product	Model	Voltage	HP	SF	Full Load Amps	Wt.
<b>High Performance Full-Rated Energy Efficient 50/60</b>						
PA011511	WFE-2	115/208-230 V	1/2	1.9	11.2/6.0-5.6	41
PA011512	WFE-3	115/208-230 V	3/4	1.67	11.2/6.0-5.6	41
PA011513	WFE-4	115/208-230 V	1	1.65	14.8/7.8-7.4	46
PA011514	WFE-6	208-230 V	1.5	1.47	9.6-9.8	54
PA011515	WFE-8	208-230 V	2	1.30	11.0-10.2	55
PA011516	WFE-12	208-230 V	3	1.15	15.0-13.6	56
<b>High Performance Up-Rated Energy Efficient 50/60 Hz</b>						
PA011517	WFE-24	115/208-230 V	1	1.25	11.2/6.0-5.6	41
PA011518	WFE-26	115/208-230 V	1.5	1.10	14.8/7.8-7.4	46
PA011519	WFE-28	208-230 V	2	1.10	9.6-9.8	54
PA011520	WFE-30	208-230 V	2.5	1.04	11.0-10.2	55

## Standard Motor Swimming Pool Pump

40% glass-filled thermoplastic with the Cam & Ramp “see thru” lid design. Self-priming, high flow with patented funnel-flo diffusers. 2 in. suction and discharge ports. Motor features threaded shaft, 56 frame and square flange.

- Built-in Strainer Pot and Volute
- Standard Motor Efficiency
- Three-year warranty

Product	Model	Voltage	HP	SF	Full Load Amps	Wt.
<b>Standard Motor 115/230 V</b>						
PA011578	WF-2	115/230 V	1/2	1.95	10.5/5.4	41
PA011579	WF-3	115/230 V	3/4	1.65	14.2/7.1	41
PA011580	WF-4	115/230 V	1	1.65	16.0/8.0	46
PA011581	WF-6	115/230 V	1.5	1.5	22.4/11.2	54
PA011582	WF-8	230 V	2	1.30	11.5	55
PA011583	WF-12	208-230 V	3	1.15	15.0/13.6	56
<b>Standard Motor Up-Rated 60 Hz</b>						
PA011771	WF-23	115/230 V	3/4	1.3	10.5/5.4	41
PA011772	WF-24	115/230 V	1	1.25	14.2/7.1	41
PA011773	WF-26	115/230 V	1.5	1.10	16.0/8.0	46
PA011774	WF-28	115/230 V	2	1.10	22.4/11.2	54
PA011775	WF-30	230 V	2.5	1.04	11.5	55
<b>3 Phase High Performance 208/220/440V 50/60 Hz</b>						
PA011568	WFK-4	208 V	1	1.65	5.0-4.6/2.3	46
PA011569	WFK-6	208 V	1.5	1.47	6.4-5.8/2.9	54
PA011570	WFK-8	208 V	2	1.30	7.1-6.8/3.4	56
PA011571	WFK-12	208 V	3	1.15	11.0-10.4/5.2	58
<b>Dual-Speed Full-Rated 230 V 60 Hz High-Speed 3450 rpm, Low-Speed 1725 rpm</b>						
PA012530	WFDS-3	115 V	3/4	1.67	14.6/4.7	42
PA011486	WFDS-4	230 V	1	1.65	7.8/3.0	47
PA011522	WFDS-6	230 V	1.5	1.47	10.0/3.5	55
PA011523	WFDS-8	230 V	2	1.30	11.0/4.0	56
<b>Dual-Speed Up-Rated 230 V 60 Hz High-Speed 3450 rpm, Low-Speed 1725 rpm</b>						
PA012485	WFDS-24	115 V	1	1.25	14.6/4.7	42
PA012518	WFDS-26	230 V	1.5	1.10	7.8/3.0	47
PA011524	WFDS-28	230 V	2	1.10	10.0/3.5	56
PA011525	WFDS-30	230 V	2.5	1.04	11.0/4.0	57

## Special Pump Lid

- PA076130 Clamp style chemical resistant lid
- PA357156 Cam/ramp chemical resistant lid

## Challenger High Pressure Pumps –

### Fiberglass Reinforced Swimming Pool Pump

Fiberglass Reinforced pump with Closed Impeller, Single Speed. Pump components are custom molded thermoplastic for superior strength and durability

- Standard 2 in. suction and discharge ports permit maximum operating efficiency
- Extra-large strainer basket extends time between cleanings
- Transparent strainer pot lid with comfortable handle provides easy access to strainer basket
- Unique diffuser and impeller provide excellent high pressure performance for all types of demanding installations
- One-bolt stainless steel clamp removes easily to provide quick access for any required service
- Power end can easily be removed for service or winterizing without disturbing piping or pump support base
- No tool required for removing thumbscrew drain plugs for draining and winterizing
- Internal components and 2 in. ports are designed to provide rapid priming and quiet operation
- Anti-spin-off impeller
- Three-year warranty



Product	Model	Voltage	HP	SF	Full Load Amps	Wt.
<b>Single-Speed Standard Motor 115/230 V Full-Rated</b>						
PA345202	CHII-NI-1/2F	115/230 V	1/2	1.95	10.8/5.4	37
PA345203	CHII-NI-3/4F	115/230 V	3/4	1.65	14.2/7.1	39
PA345204	CHII-NI-1F	115/230 V	1	1.65	16.0/8.0	41
PA345201	CHII-NI-1.5F	115/230 V	1	1.50	22.4/11.2	49
PA345218	CHII-NI-2F	230 V only	2	1.30	11.5	55
PA345219	CHII-NI-3F	208-230 V	3	1.15	14.1	55
<b>Single-Speed Standard Motor Up-Rated</b>						
PA346203	CHII-NI-3/4A	115/230 V	3/4	1.30	10.8/5.4	37
PA346204	CHII-NI-1A	115/230 V	1	1.25	14.2/7.1	39
PA346206	CHII-NI-1.5A	115/230 V	1.5	1.10	16.0/8.0	41
PA346201	CHII-NI-2A	115/230 V	2	1.10	22.4/11.2	49
PA346249	CHII-NI-2.5A	230 V	2.5	1.04	11.5	55
<b>Single-Speed Energy Efficient Motor Full-Rated</b>						
PA345212	CHII-NI-1/2FE	115/208-230 V	1/2	1.90	11.2/6-5.6	37
PA345213	CHII-NI-3/4FE	115/208-230 V	3/4	1.67	11.2/6-5.6	43
PA345205	CHII-NI-1FE	115/208-230 V	1	1.65	14.8/7.8-7.4	48
PA345206	CHII-NI-1.5FE	208-230 V	1.5	1.47	9.6/8.8	49
PA345208	CHII-NI-2FE	208-230 V	2	1.30	11.0-10.2	55
PA345209	CHII-NI-3FE	208-230 V	3	1.15	15.0-13.6	55
<b>Single-Speed Energy Efficient Motor Up-Rated</b>						
PA346223	CHII-NI-3/4AE	115/208-230 V	3/4	1.25	11.2/6-5.6	37
PA346205	CHII-NI-1AE	115/208-230 V	1	1.25	11.2/6-5.6	43
PA346207	CHII-NI-1.5AE	115/208-230 V	1.5	1.10	14.8/7.8-7.4	48
PA346208	CHII-NI-2AE	208-230 V	2	1.10	9.6-8.8	49
PA346209	CHII-NI-2.5AE	208-230 V	2.5	1.04	11.0-10.2	55
<b>Single-Speed Single-Phase 50 Hertz</b>						
PA345803	CHII-NI-3/4	50 Hz, 120/240 V	3/4	1.10	15.0/7.5	43
PA345804	CHII-NI-1	50 Hz, 120/240 V	1	1.10	13.8/6.9	48
PA345806	CHII-NI-1.5	50 Hz, 240 V	1.5	1.10	7.2	49
PA345808	CHII-NI-2	50 Hz, 240 V	2	1.10	9.4	55
PA345809	CHII-NI-3	50 Hz, 240 V	3	1.10	15.0	55

## C Series Commercial Brass Pumps –

### With Hair and Lint Pot

Brass volute and pot, coated cast iron foot, flanged connections, 6 in. suction, 4 in. discharge

- Large commercial pump with s/s basket
- Easy serviceability
- All-bronze construction for strength and durability
- 6 in. suction and 4 in. discharge for maximum capabilities
- Heavy-gauge stainless steel strainer basket with an open area 5 times the area of the suction port
- Closed impeller for longer motor bearing life
- Heat-resistant seal capable of operation at up to 150 degrees Fahrenheit
- Available in single and three phase, 50 and 60 Hertz models
- One-year warranty

**Call for further information and ordering**